

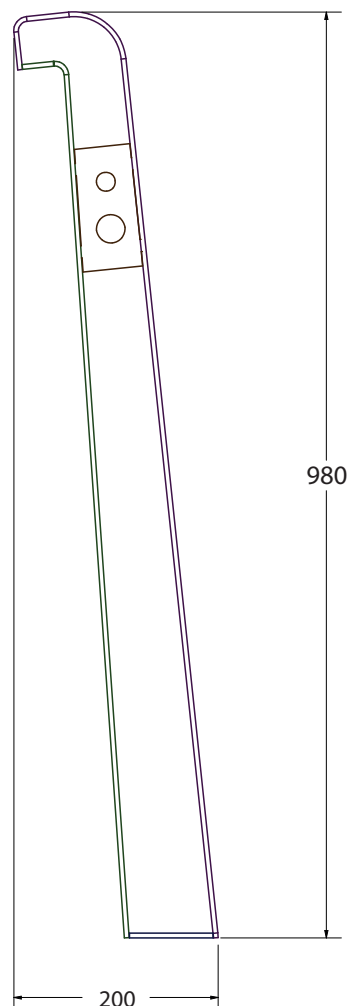
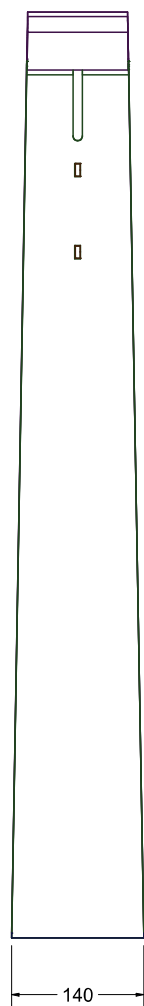
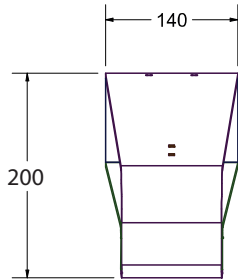

**Max Dimensions:**

Height: 980 mm | Length: 140 mm | Width: 200 mm  
Underground (on request): 250 mm | Weight: 11 Kg

**Description:**

The bollard/bike rack Hi Bollard is made in steel of 50/10 thickness. On the upper part of the bollard there are 2 holes of 20 and 30 mm diam. On the inner and middle part of the Hi Bollard a strong steel plate of 50/10 thickness is welded. For the fixing to the ground through specific bolts (not provided), there is a flange of 140x100 mm with 4 holes of 10 mm diam. or an underground extension of 250 mm, for the fixing with the appropriate cementation. For the realization of this product, Steel EN10111DD11 is used and later treated with a cycle of sandblasting, cataphoresis and powder coating. Such cycle is meant to guarantee the protection of the painted products, in an environment of C4 corrosion class, as requested by the UNI regulations EN ISO 12944-2. The products are eventually polyester-powder coated with RAL colours at choice.